

# LED Single and 3 Light Puck Kit Installation Instructions

**NOTE: Turn power off before wiring. Failure to do so will short out pucks.**

## Installation

1. Recessed - Cut a 2-1/4" hole in a desired location. Remove puck light from surface mounting ring (Fig. 1). Push Puck Light up into hole where springs enable a snug fit (Fig. 2).
2. Surface Mount - Install surface mounting ring with 2 screws (supplied) in the desired location making sure that wires are routed through notch cut in surface mounting ring. Push recessed puck light up into surface mounting ring, enabling springs to secure a snug fit (Fig. 3).
3. Wiring multiple single LED pucks in 'series' - Wire the first puck to the LPCC-18 700mA constant current LED power supply. Consult wiring diagram below.

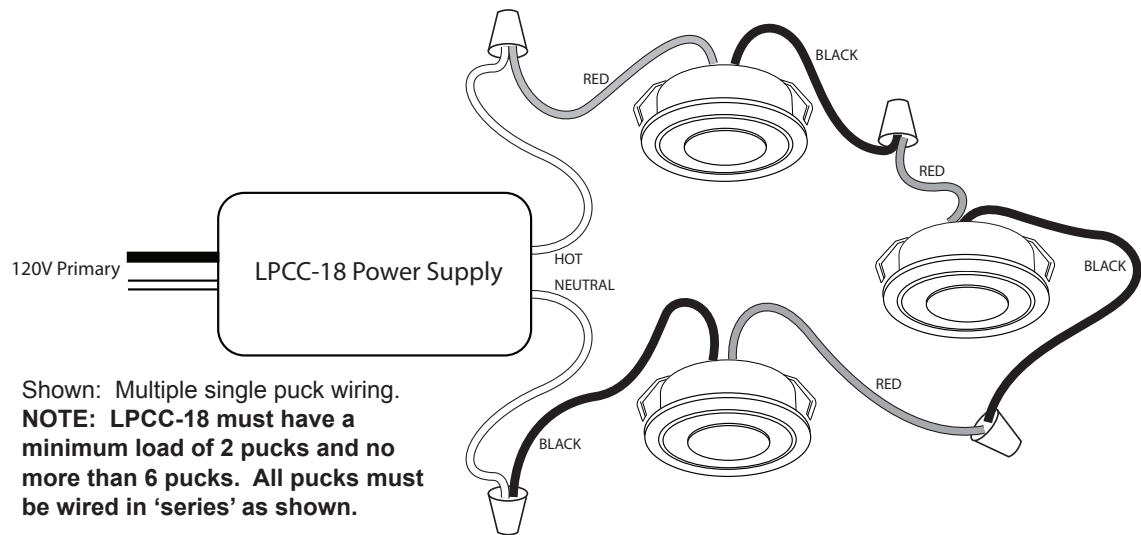
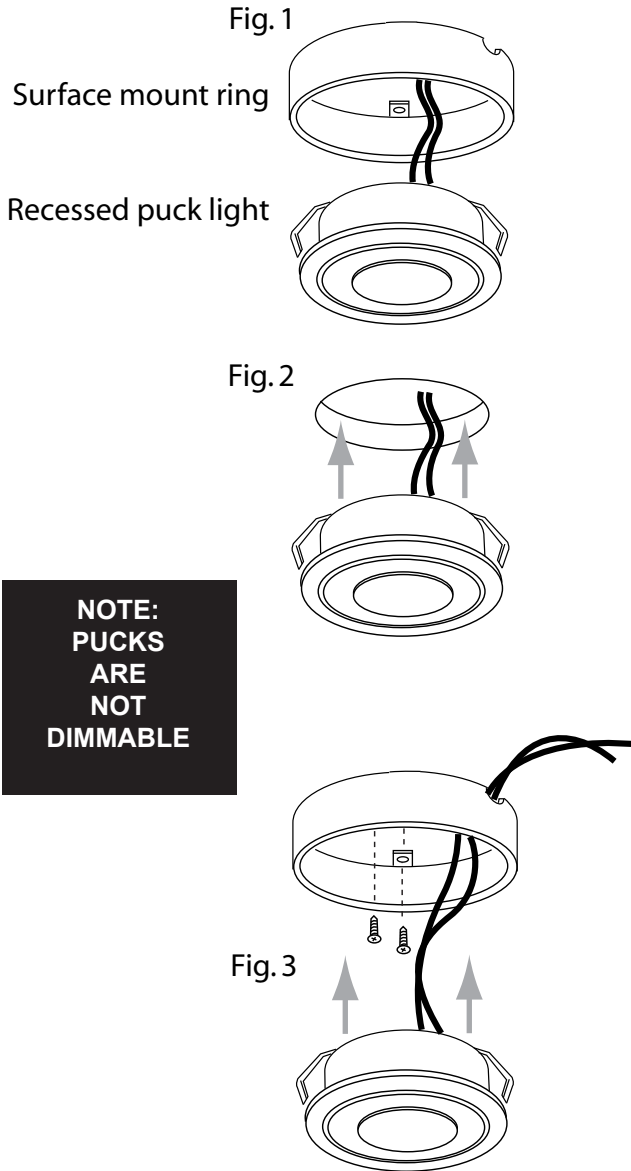

## Electrical Connection: 3 Puck Kit

1. Locate position of pucks and install either surface or recess mount.
2. Connect modular connectors to power supply and each puck.
3. Plug in power supply into nearby power outlet.